

BASEMENT LEVEL NOTES:
 FROST LINE DEPTH AT WALKOUT TO BE 18"

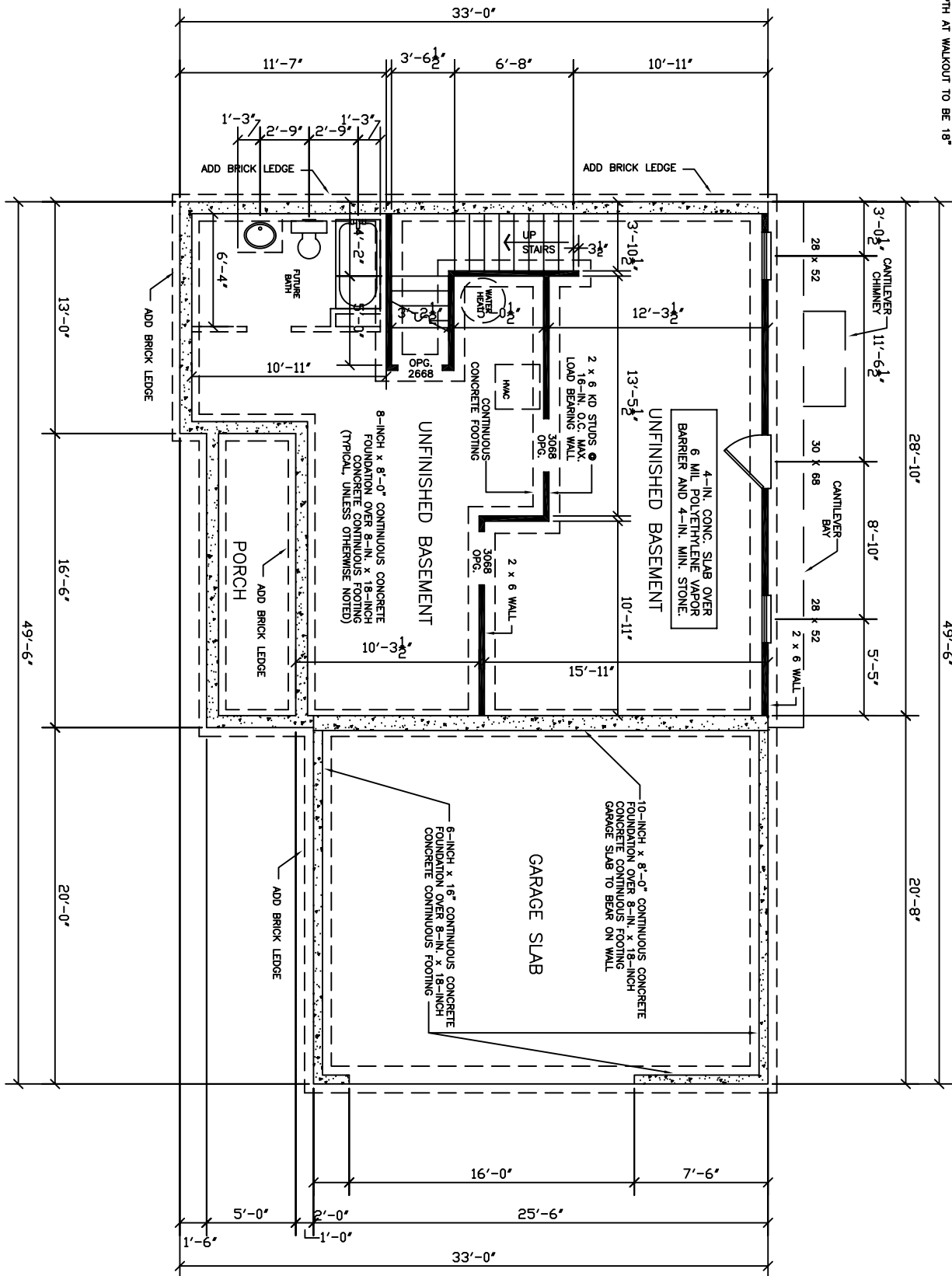

BASEMENT FOUNDATION PLAN

THE JESSAMINE PARK
 Lot 6

DESIGNED BY
 FRANK BETZ ASSOCIATES, INC.
 1800 LAKE PARK DRIVE/SUITE 101
 SMYRNA, GEORGIA 30080
 404/431-0888



www.virginiaridge.com



ARGABRIGHT
 CONTRACTORS, INC.
 540-580-8138

DATE:
 03/01/05
 SHEET:
 B-1